

South Carolina  
Greenville District

Pursuant to a Warrant from Wm D. Thomas Esq. Com. dated the 7<sup>th</sup> Nov. 1809 I have admeasured & laid out unto John West a tract of one hundred & five acres of land situate in Greenville District on both sides of two branches of the waters of Enoree River bounded to the N.E. & S.W. on P. M. Ayres's Land to the S.E. on Martin Ayres's Land & B. Bruce's land and hath such shape form and marks as the above plat represents. Surveyed the 8<sup>th</sup> Nov. 1809 Recorded the 14<sup>th</sup> Nov. 1809 Del. J. Young D.S.

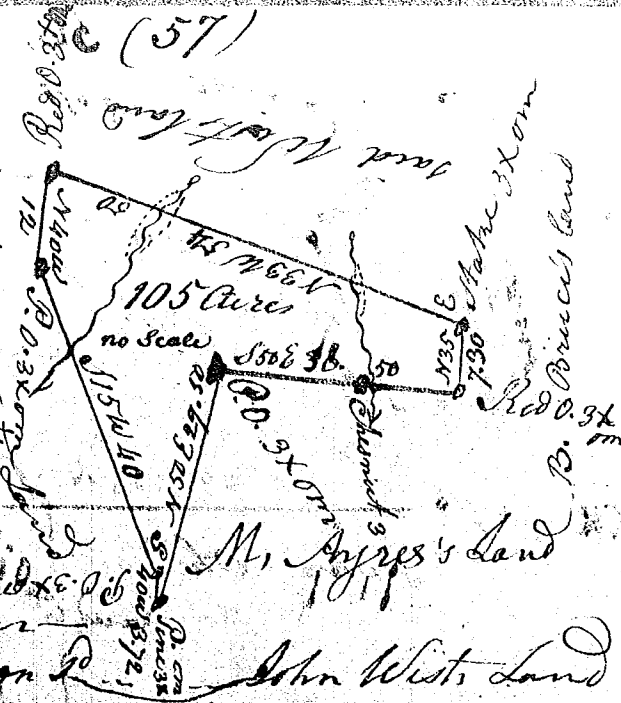

South Carolina

Pursuant to a Warrant from Wm D. Thomas Com. of Greenville dated the 20<sup>th</sup> Nov. 1809. I have admeasured & laid out unto John Cochran a tract of land containing One Hundred & Eight acres, situate in the District on the N.W. of Hogback Mountain on a branch the waters of Greeny creek bounded by a line running by land survey on the N.E. by land survey for J. M. May will all other sides vac. & hath such form & marks as the above plat represents.



Surveyed the 22<sup>nd</sup> Nov. 1809. J. W. White D.S.  
Recorded this 15<sup>th</sup> Jan 1810 Del. J. Young